

PEGASUS ASSEMBLY INSTRUCTIONS

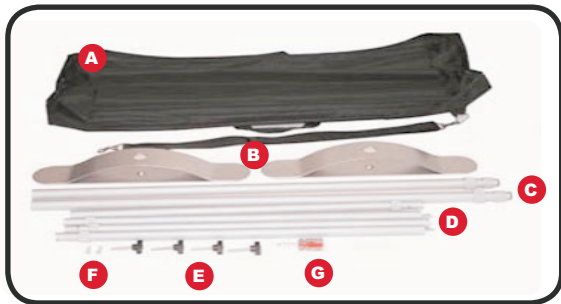

Kit includes: (A) Case, (B) 2 x feet, (C) 2 x Telescopic upright poles, (D) 4 x Top and bottom graphic poles, (E) 4 x Thumb screws, (F) 2 x Screws, (G) 1 x Screwdriver

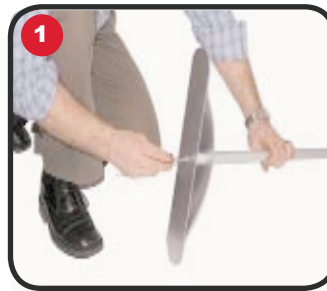

1 Assemble the telescopic uprights and feet using the supplied screws and driver.



2 Align mounting holes to face the fat sides of the feet.



3 Locate and match the top and bottom graphic poles. They are identified by stickers near the shaped ends.



4 Screw each the top and bottom poles to their partner.



5 Attach the bottom pole to one of the upright assemblies, and adjust to the width needed.



6 Attach the top pole to the same upright assembly, and adjust to the width needed.



7 Slide the graphic over the unattached end of the top and bottom poles using the pole pocket.

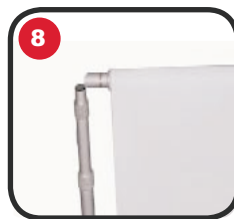

8 Attach the loose end of the top and bottom graphic poles to the other upright pole.

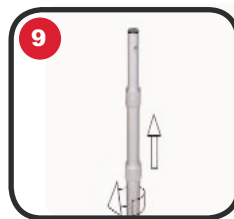

9 Adjust each of the poles as needed by twisting the locking ring to the left to loosen and to the right to tighten.

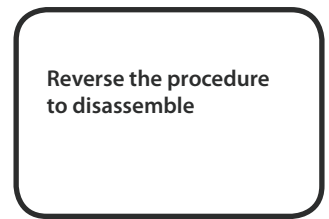

Reverse the procedure to disassemble