

# PACIFIC ASSEMBLY INSTRUCTIONS

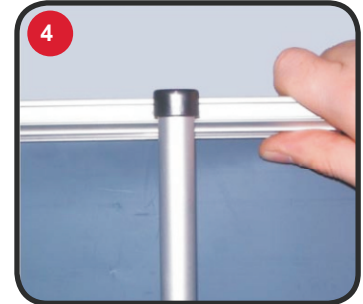
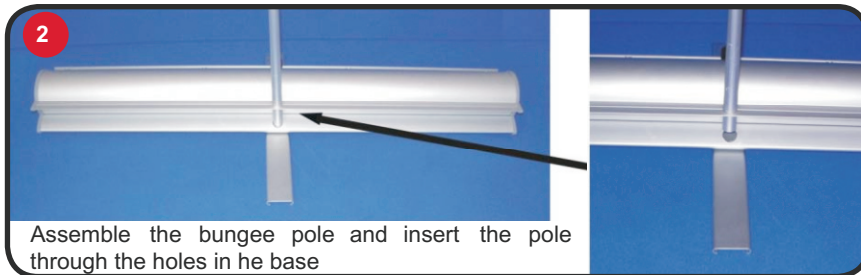
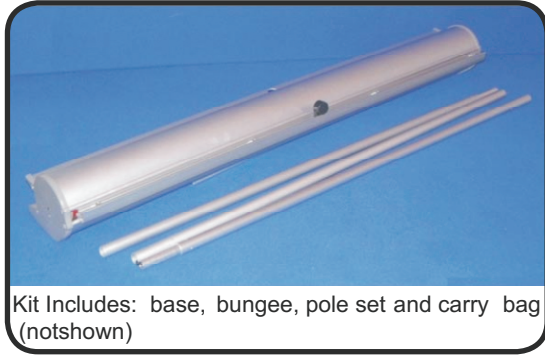

## Guidelines for Graphic Substrates

1. Material thickness must be between 0.0089" and 0.0118" in total
2. The substrate must be pliable and suitable for roller banner stands
3. After fitting, the graphic should be left for 24 hours before use to ensure the adhesive bonds sufficiently

## Notes

Take care when lowering the banner (do not drop) to prevent damage to the graphic.