

# SPINNAKER ASSEMBLY INSTRUCTIONS

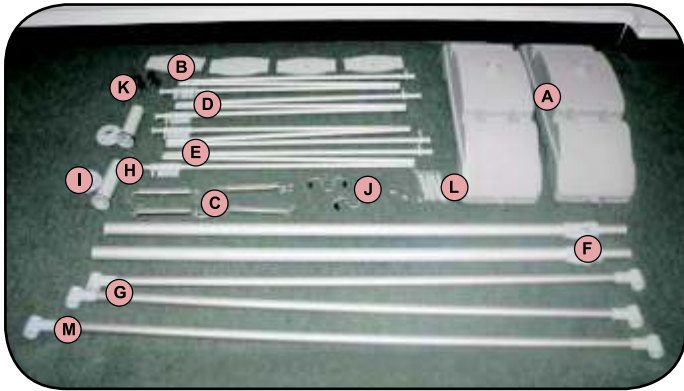

所需零件數目:

- 2 x base tanks (A)
- 4 x base covers (B)
- 4 x base springs (C)
- 2 x top bungee poles (D)
- 2 x bottom bungee poles (E)
- 2 x telescopic support poles (F)
- 2 x base poles (G)
- 2 x hollow base tubes (H)
- 2 x base screws (I)
- 2 x graphic support hooks (J)
- 2 x telescopic support pole screws (K)
- 4 x spare bungee ends (L)
- 1 x top support pole (M)

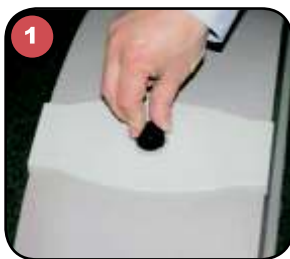

1  
Unscrew the 4 base screws from the base tanks and put to one side.



2  
Lift off the 4 base covers and put to one side.



3  
Unfasten the base screws from the base tank.



4  
Remove the base tubes from the base tank. Fill each tank with water or sand, then re-fit the base tubes and fasten the screws.



5  
Take the 2 base poles and slot into each base tank. Repeat for the 2nd tank.



6  
Re-fit the 4 base covers.

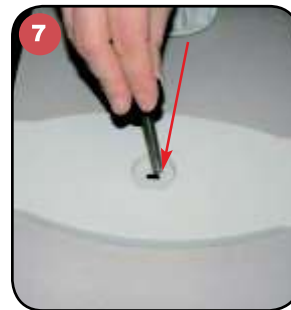

7  
Fasten the 4 base screws to secure.



8  
Unfasten the screw from the top of each telescopic support pole and put to one side.

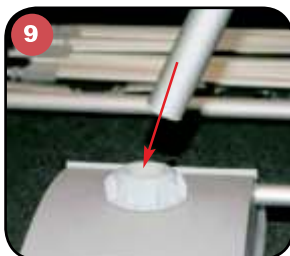

9  
Take a telescopic pole and insert into the base tank. Repeat for the 2nd tank.



10  
Fit the top support pole over the top of each telescopic pole and secure with screws removed previously.

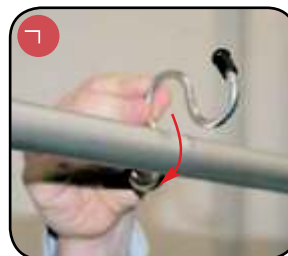

11  
Place the 2 graphic support hooks over the top support pole.

# SPINNAKER ASSEMBLY INSTRUCTIONS

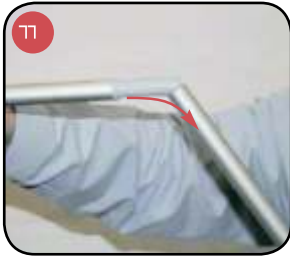

11 Assemble 1 top bungee pole and 1 bottom bungee pole.

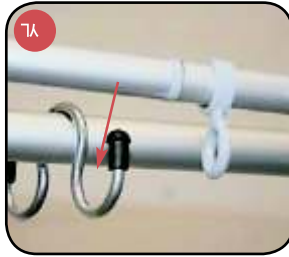

12 Rest the top bungee pole (pole WITHOUT metal rings) onto each support hook.

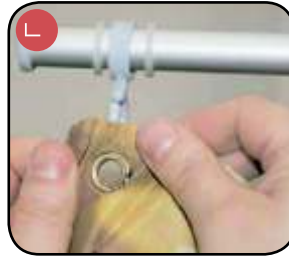

13 Take the top horizontal edge of the graphic and attach each eyelet onto the plastic hooks on the top bungee pole. Space out evenly.



14 Attach the base springs to each base tank ring.



15 Attach the other end of the base spring to the bottom bungee pole ring.



16 Take the bottom horizontal edge of the graphic and attach each eyelet onto the plastic hooks on the bottom bungee pole. Space out evenly. For double sided display repeat steps 14 to 17 for the 2nd graphic.



17 Unlock one telescopic support pole and raise up the graphics to the desired height.



18 Lock the telescopic support pole into place. Repeat for the 2nd support pole.

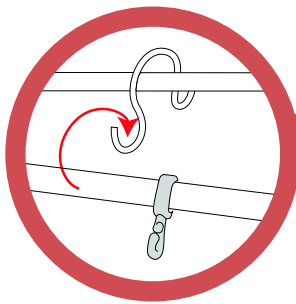

Illustration to show how graphic fits to the frame, each graphic eyelet attaches to hooks on the horizontal bungee poles.

